

Traffic, Transport and Travel Working Group

Report by Andy Martin, Helen Durrant and Sam Richardson

Date 2 May 2024 (for PC Meeting 7 May 2024)

We met with CCC Highways on Friday 8th March 2024 to walk through LHI bid. Letter sent to GCP on 18th March 2024 raising concerns about Barton Greenways plans. Constructive follow up meeting with the Greenways team on Friday 26th April 2024.

20 mph

Monitoring with MVAS continues. Asked for extension of 20 mph zone to edge of the housing on Caomberton Road in response to 20 mph schemes.

Barton Greenways

A letter was sent to Peter Blake at GCP to raise concerns about certain aspects of the Barton Greenways project. A reply was sent from the GCP:

We have spoken with the project team who have provided the following responses to your four key points:

Zebra Crossing

The zebra crossing proposed is as per relevant current design standards and therefore we will not be able to change this design. The design of the zebra crossing has not changed since the consultation in 2022.

Pedestrian Crossing

Given the traffic flows along New Road, engineers proposed that simply adding speed humps would be very effective in slowing down traffic.

High Street Calming

We welcome your views on this and we will look to incorporate your suggestions into a revision of our design. On completion we will then be in contact to share the revised designs with you.

Give-Way Chicane

The chicane was introduced at a later design stage following request from the residents of Barton Village. We have proposed the chicane at the most appropriate and safe location that meets the required design standards. This is a balanced solution that increases cycle safety (accessing and egressing the shared use facility) and also helps reduce speeds at this location without the introduction of a parallel crossing (which would be the alternative solution to provide a safe facility for cyclists to go from the shared use footway to the carriageway). The guidance allows for a 2.7m flushed kerb to allow cyclists onto the carriageway however we have improved this and are proposing a 5m flushed kerb which would cater for larger bicycles (cargo / trailers) or for multiple cyclists at once.

As a follow up to the letter, a meeting was held with Barton Greenways team on 26th April to discuss the letter in more detail and to challenge responses to our letter. Changes have been discussed and will be reviewed by the team. These include replacing the zebra crossing at Kings Grove with a raised table, adding a zebra crossing outside the school, replacing the chicane outside the farm cottages on Comberton Road with a raised table and extending the 20 mph zone further out from the village. We also discussed the addition of a raised table at the end of High Street with improved drainage. Improved drainage may ease the risk of flooding at the pond and help protect property opposite. The team were also receptive to increasing the green space were the slip road between School Lane and High Street will be removed.

[Barton Greenway \(greatercambridge.org.uk\)](http://greatercambridge.org.uk)

New contact is Daniel Jackson Greenways projects. (Daniel.Jackson@cambridgeshire.gov.uk).

EWR

I attended a call with other local Parish Councils organised by the Cambridge Approaches team on Monday 29th April 2024. This was organized by David Revell (Haslingfield PC) and attended by William Harold (Cambridge Approaches) and members from 16 Parish Councils from south of A428. Most are directly impacted by the proposed EWR route. The objective of the meeting was to agree on a set of joint actions so as to carry more weight than from a single PC.

David presented some maps showing the part of the proposed route from Cambourne to Harston with plots of land likely to be used during construction. The construction time frame could be 6 to 15 years with widespread disruption to the area in a similar way that the A14 build caused major issues for locals along the route.

From the discussion, it seems that a date 24 June 2024 will be the start of the statutory public consultation and that it will last 8 weeks. Also, it seems clear that a major driver for the build is the growth of Cambourne. Likely to be up to 53,000 houses (five-fold increase).

It seems that SCDC is in favour of EWR as are local Liberal Democate Candidates Pippa Heylings and Ian Sollom. Chris Carter-Chapman (Conservate) is against EWR and Anthony Browne is probably now in favour.

Draft letters should be available for us to review and sign up to (or not). These seem to be focussed on technical issues such as “Statement of Community Consultations”, that did not include Parish Councils, and “Land Interest Questionnaires” that don’t impact Barton.

[Cambourne to Great Shelford – Cambridge Approaches](#)

Below are screen shots of the presentation:

• Attendees from 16 local PCs

- Highfields-Caldecote
- Toft
- Hardwick
- Kingston
- Comberton
- Bourn
- Eversdens
- Harlton
- Barton
- Haslingfield
- Barrington
- Harston
- Newton
- Hauxton
- Little Shelford
- Great Shelford

Direct impacts

- Road traffic delays (construction traffic, road closures)
- Road damage (heavy lorries)
- Train cancellation & delays (possessions and blockades, works overruns)
- Work sites land-take (farmland, property possessions)
- Environmental (air, noise, visual, ecological)
- Property – loss of value
- Property – compulsory purchase & compensation

Programme duration

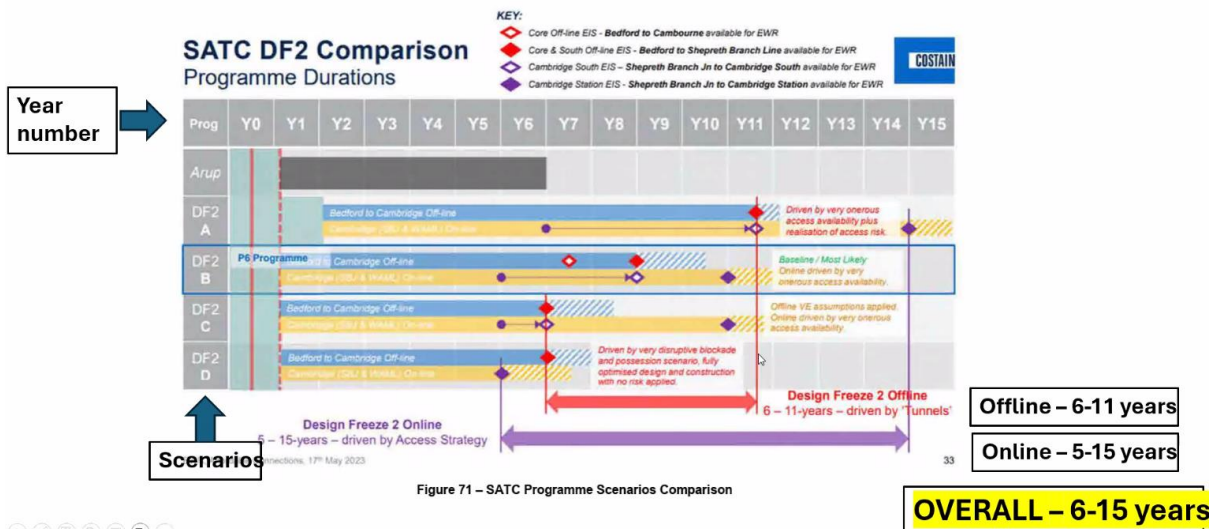

Land Interest Questionnaires (LIQs) & Jan 22 route

- EWR Co sent LIQs to residents in late March 24
- Basis for choosing which residents should receive LIQs unclear
- Cambridge Approaches obtained drawings of route under FOI
- Review of route
 - Highfields-Caldecote
 - Comberton & Toft
 - Harlton

Highfields-Caldecote

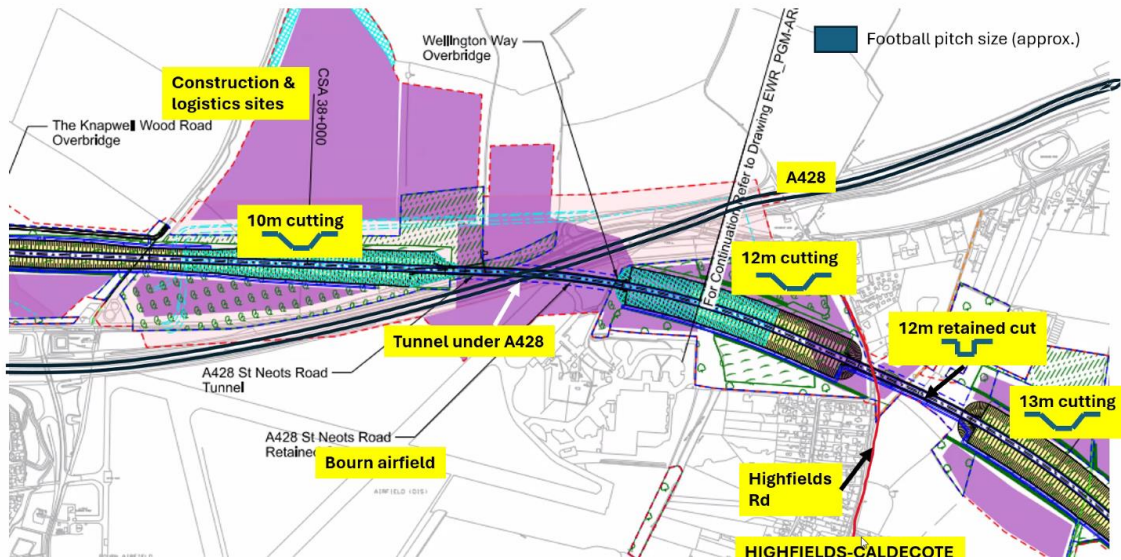

Comberton & Toft

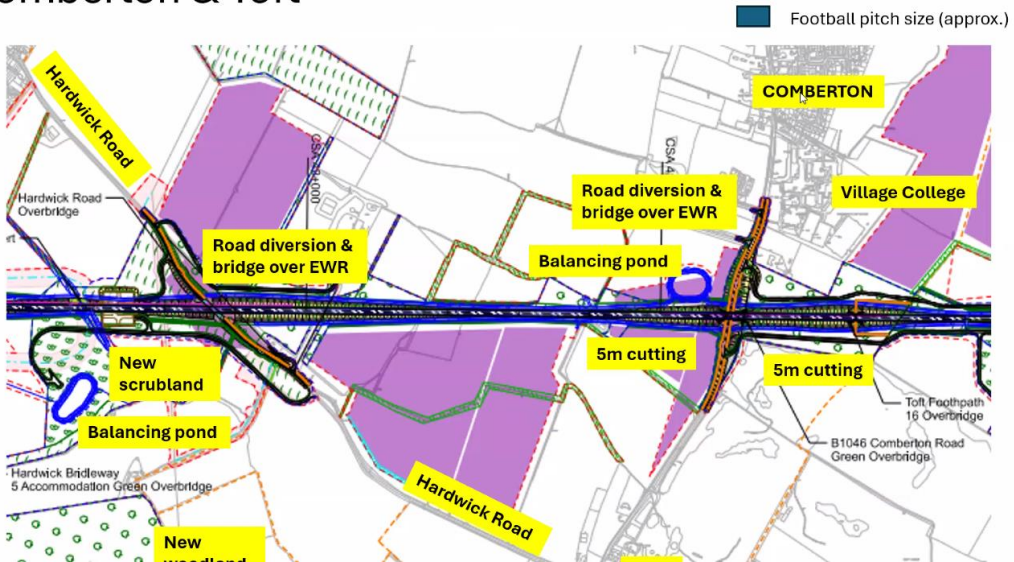

Harlton

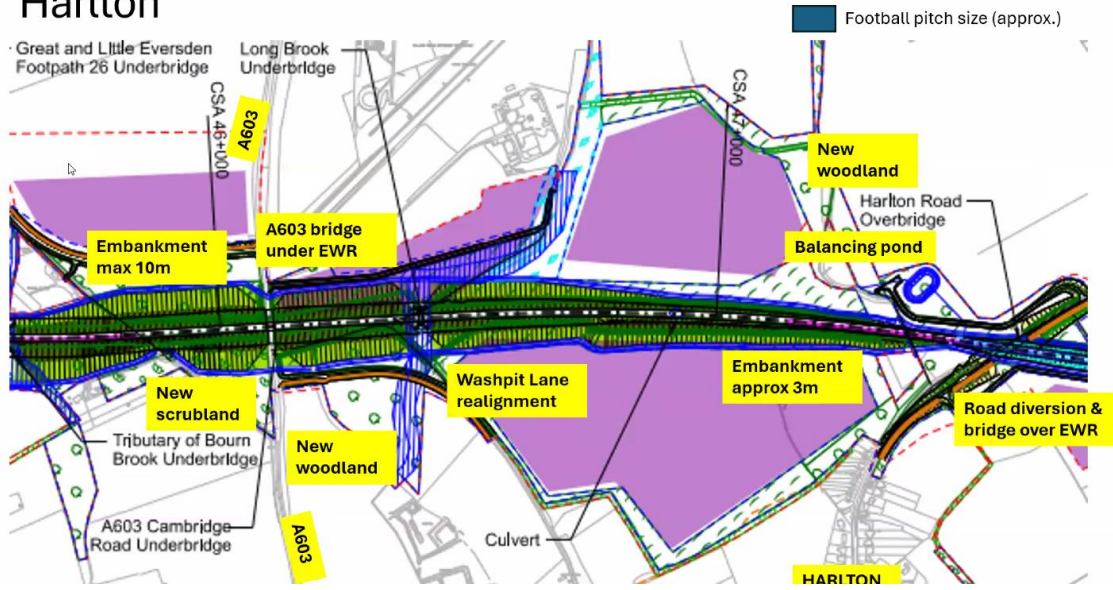

Layby Cambridge Road

Lance Raynor has paid for work on the drainage in front of his property with approval from CCC Highways. We thank Lance for this. Hopefully the improved drainage will help with other issues at this site. Highways filled the large pothole and repaired the grass verge opposite.

LHI

LHI bid submitted:

- 40 mph buffer from Lordsbridge to Barton with village gates at speed limit change points, extend the footpath to Trumpington Estates permissive routes.
- Speed cushions or chicanes on Haslingfield Road.

Confirmation that the bid has been received and a site visit was made with Ross Lewis on 8th March. Ross witnessed the issues with speeding faced and will work up plans and costing.

Current LHI Cost Commitment

2021/22 Paid £12,867.89

2022/23 Came in well under budget at £885 instead of £5000.

Mailes Close street sign & School Lane signs

No action taken yet on signs. School Lane needs to wait until Barton Greenways work is finished.

MVAS System (VIASIS 3003)

New MVAS is currently on Wimpole Road area. Old MVAS is currently on Comberton Road in 20 mph.

V85 is the key number that Highways is interested in. So far, we have V85 data showing:

- Comberton Road (40 mph section) 45 mph (top speed 97 mph)
- Foxcotes, Comberton Road 35 mph (towards Barton, 70 mph top speed)
- 17, Comberton Road 32 mph (towards Comberton, 59 mph top speed)
- Haslingfield Road 40 mph (top speed 72 mph)
- Wimpole Road 44 mph traffic leaving Barton (top speed 90 mph)
- Wimpole Road 48 mph traffic entering Barton (top speed 96 mph)
- New Road 38 mph (40 mph limit)

- New Road 28 mph (30 mph limit) in front of the school
- New Road 34 mph (30 mph limit) corner 50 m from Kings Grove (top speed 68 mph)
- New Road 32 mph (20 mph limit) corner 50 m from Kings Grove (top speed 76 mph)
- High Street 29 mph (top speed 68 mph)

Pollution Monitor

The pollution monitor is up and running. Realtime data can be viewed on:

EarthSense website: <https://portal.earthsense.co.uk/SouthCambsCouncilPublic/>

Real Time Passenger Information (RTPI)/No 18 Bus/No 75

RTPI signs have been installed and contact with Whippet made with Ed Cameron at Whippet for timetable updates (ed.cameron@whippet.uk.com).

Still no feedback of request for a bus stop at the Lordsbridge hamlet on A603.

Email: zaneta.adamczyk@cambridgeshirepeterborough-ca.gov.uk

Web: www.cambridgeshirebus.info

Mobile App: MyBusTrip

Minor Road Faults

Dozens of faults with Barton Parish have been reported and many pot holes have been filled. However, many more pot holes are appearing with all the rain we are having. Standing water is still an issue but does drain away within a day or two once the rain stops. Surface repairs were made to shallow potholes along the A603 Cambridge Road on 27th April 2024.

<https://highwaysreporting.cambridgeshire.gov.uk/>

Our MP Anthony Browne has put out a survey about the state of our roads which includes more wider road subjects such as A428 upgrade, congestion charging and support for Girton Interchange. (See our website post for details.)

Speed Camera

No update.

Speedwatch

We still need volunteers for Speedwatch as we have only performed a few this year.

Councillors

Andy Martin, Helen Durrant, Sam Richardson

MVAS Locations and Licenses

Column number	Postcode	Road	License
L4PCL	CB23 7BA	9 Comberton Road	CCC12513877
L9PCK	CB23 7BG	Barton Rec	CCC12513877
L5PCH	CB23 7AG	Haslingfield Road	CCC12513877
L4PCS	CB23 7AY	New Road	CCC12513877
L13PCS	CB23 7AY	New Road	CCC12513877
L12PCS	CB23 7AY	33 New Road	CCC391670356
L15PCS	CB23 7AY	New Road (school)	CCC180987655
L10PCL	CB23 7BA	17 Comberton Road	CCC180987655
L13PCL	CB23 7BA	Foxcote Fencing	CCC180987655
Dedicated Pole	CB23 7AX	Cambridge Road (Roman Hill)	
Dedicated Pole	CB23 7BA	Comberton Road (new 40 mph zone)	
SC25	CB23 7AW	94 Wimpole Road	CCC12513877

?? (CCC): street.lighting@cambridgeshire.gov.uk

Helen Taylor (SDC): Taylor Helen <Helen.Taylor@scambbs.gov.uk>

Technical Specifications for licenses

MVAS VIASIS 3003 Dimensions and weight (reference manual) page 82

4-02536 20SM0240 (replacement 9 December 2020)

5-06565 23SM0388 (new 26 September 2023)

640 x 548 x 185 (mm)

Unit weight 12 kg

Battery weight ~6 kg

Combined weight ~20 kg

Speed Watch Locations

Site No	Road Name/Route	Town/Village	Speed Limit
35SC143	New Road	Barton	30
35SC144	7 Comberton Road	Barton	30
35SC269	13/17 Comberton Road)	Barton	30
35SC269	Foxcote Comberton Road	Barton	30
35SC146	14 Haslingfield Road	Barton	30
35SC283	94 Wimpole Road (outbound)	Barton	30
35SC284	84 Wimpole Road (inbound)	Barton	30
35SC285	Cambridge Road	Barton	40
35SC206	Mailes Close/High Street	Barton	30

Additional sites surveyed by Andy Boylett (area coordinator) on 6th March 2020 approved 12 May 2021.

Amanda Large (Area Coordinator)

Speedwatch (Cambs) <speedwatch@cambs.pnn.police.uk>