

Greenways Update

19:30 to 21:30
Barton Village Hall
1 July 2025

Update

- New Road Phase One
- Kings Grove Phase Two
- Zebra Crossing Discussion Kings Grove
- High Street/School Lane Phase Three

New Road Phase One

- Open to traffic 16 June 2025
- Lampposts to go in (under two-way lights)
- Final surface
- Road surface and lining

Cake Competition Winners

Phase Two

- Under two-way lights: 2a, 2b
- Three-way lights: 2c

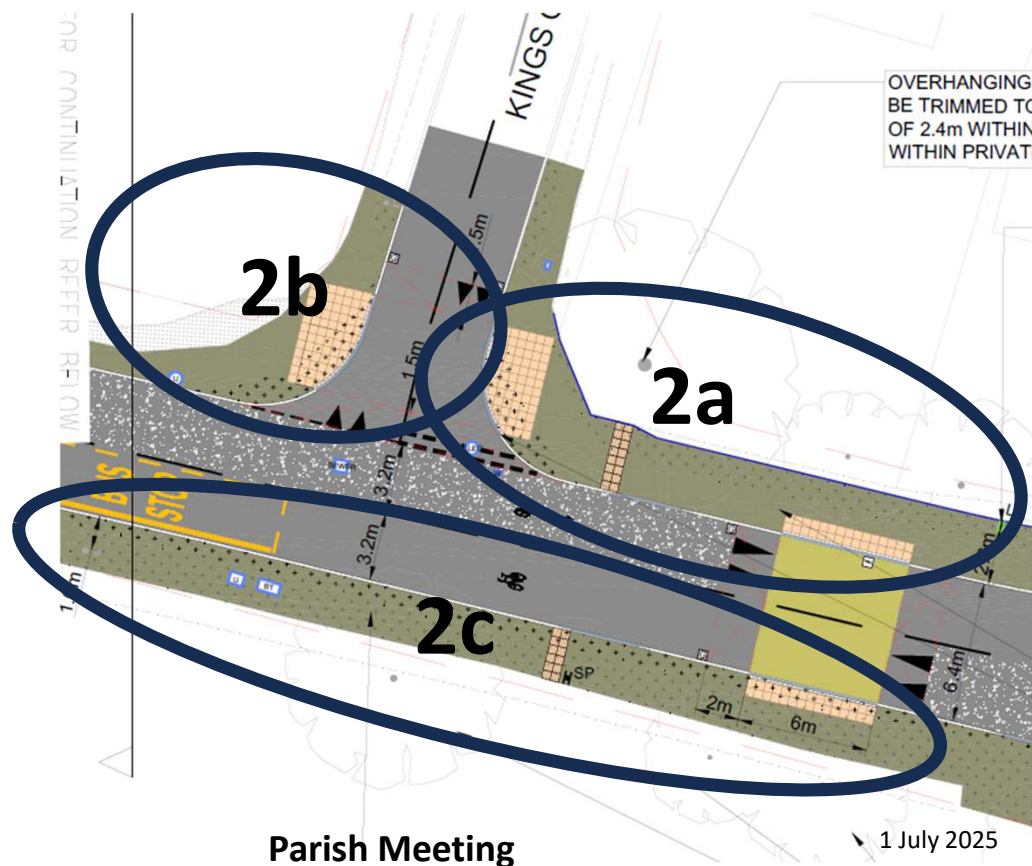

Phase Three

- Slip road remains open when High Street is closed
- School Lane closed with limited access for residents via pub carpark

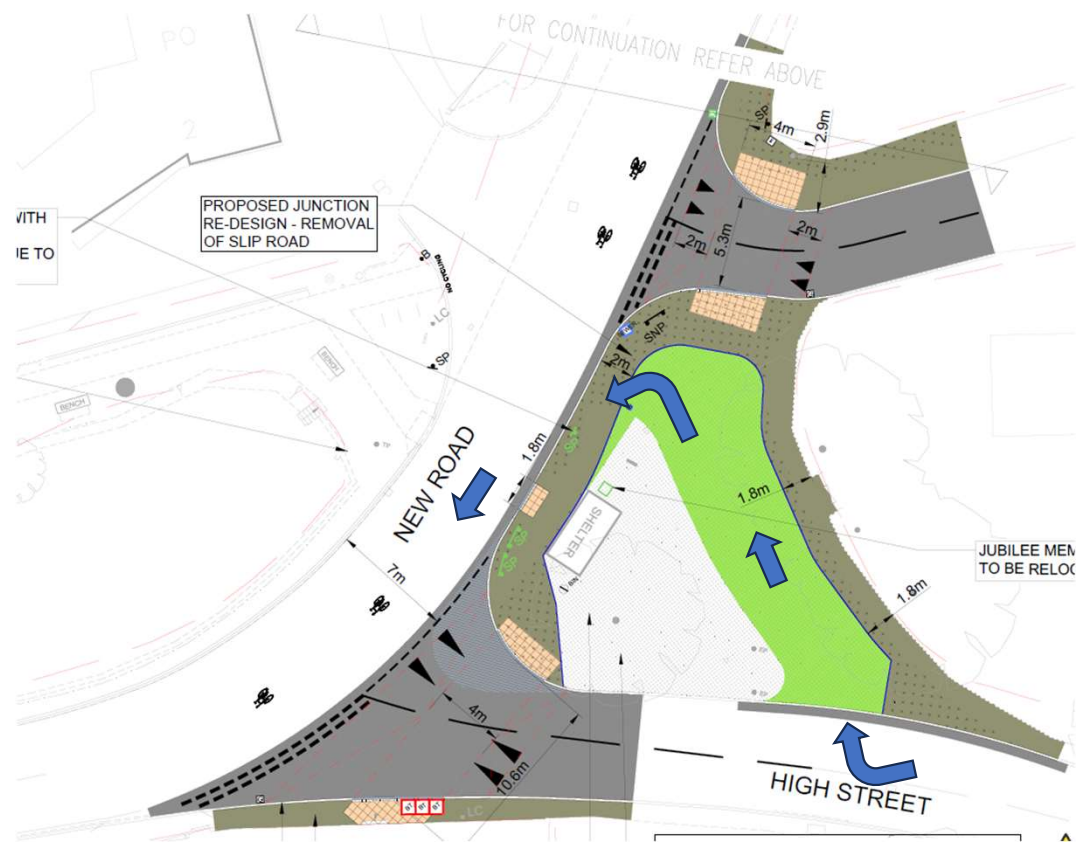

Zebra Crossing vs Table

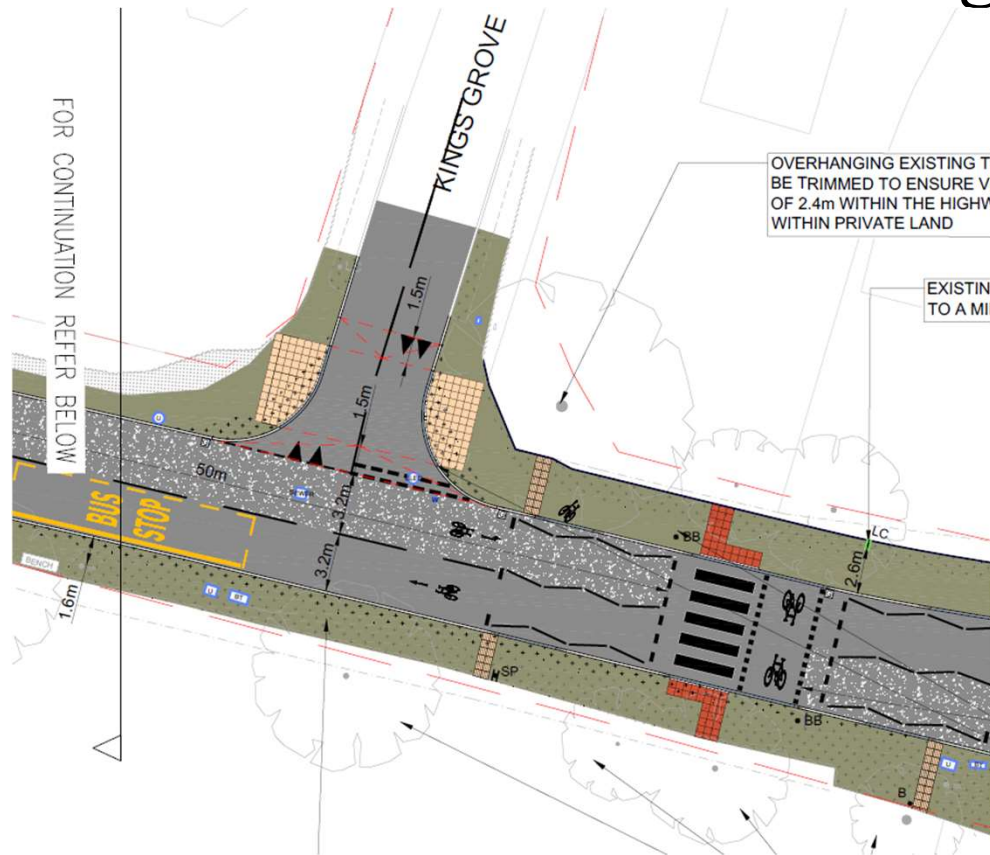

- Changes priority from vehicles using the carriageway to pedestrians and cyclists joining the carriageway
- Table devalues overall scheme as we provide safe road for cyclists but do not provide a safe entry onto the road

Ethos of Greenways

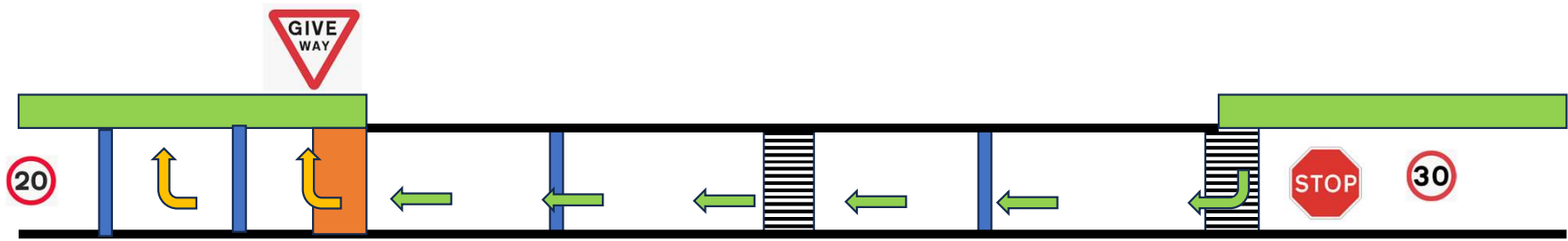
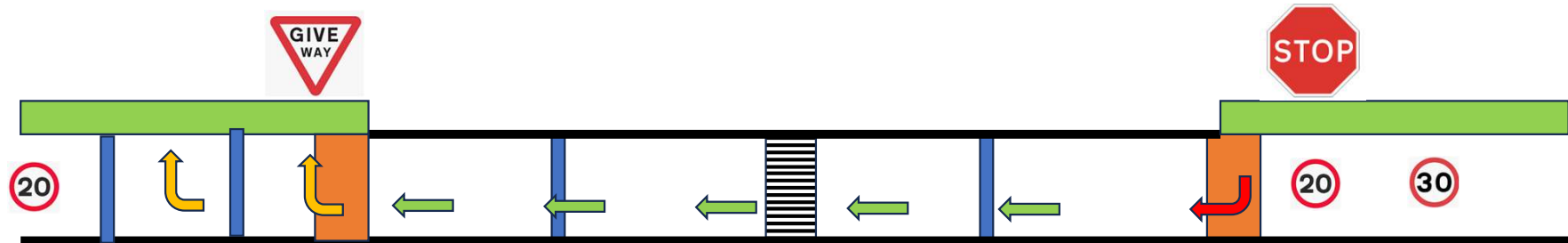
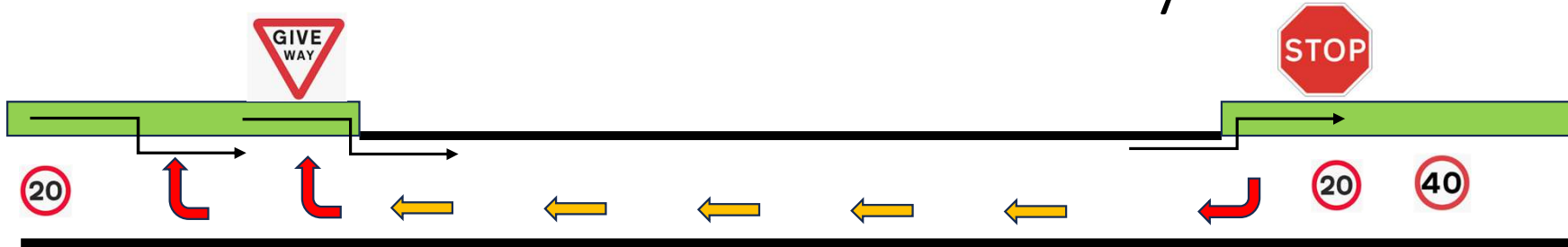

Additional Crossing?

- 6 Houses Perennial Retirement
- Safe Crossing
- Slow traffic coming into village
inside new 20 mph zone

